

ASEPT® Drainage Bag Kit Procedure

A Step-By-Step Guide

The ASEPT® Drainage Bag Kit is to be used only for peritoneal drainage with the ASEPT® Peritoneal Drainage Catheter, which is included in the ASEPT® Peritoneal Drainage System. This poster should be utilized as a guide only. Read and refer to the Instructions for Use for detailed directions, warnings, precautions and other important product and procedure related information.

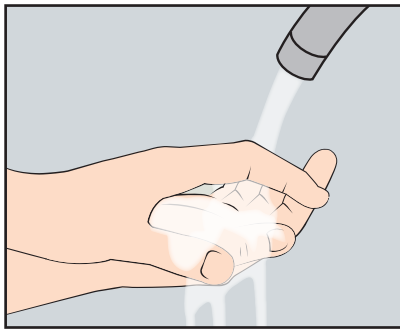

Wash your hands with soap and water for at least one minute. Remove the catheter dressing. If signs of infection are present, do not continue. Contact your doctor or nurse.

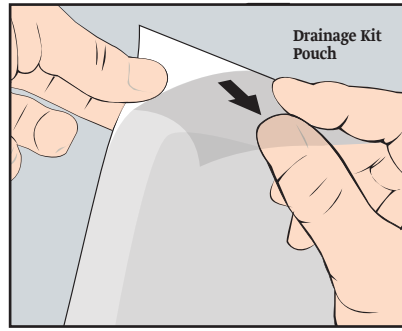

Starting at the top, peel open the drainage kit pouch all the way and remove the procedure pack.

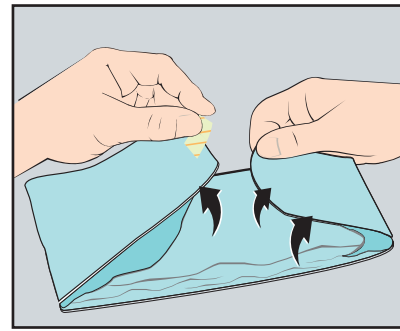

Peel open the procedure pack. Remove the tape and unfold the blue wrapping. Leave the enclosed items on the wrapping.

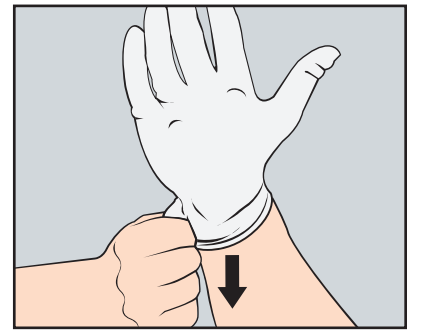

Pick up one glove by the wrist and put it on. Pick up the other glove by the wrist and put it on the other hand. Both gloves fit either hand.

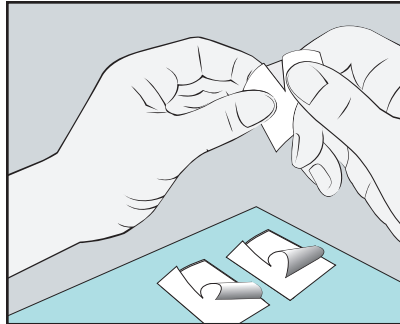

Tear open the three alcohol pads but do not remove the pads from the pouches. Place the pads on the blue wrapping.

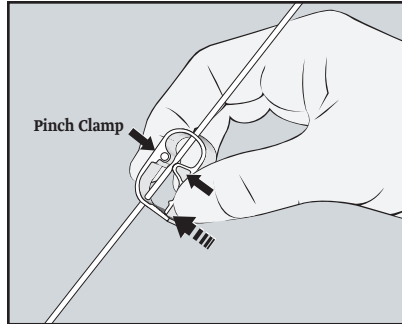

Pick up the drainage bag and squeeze the pinch clamp on the drain line completely closed.

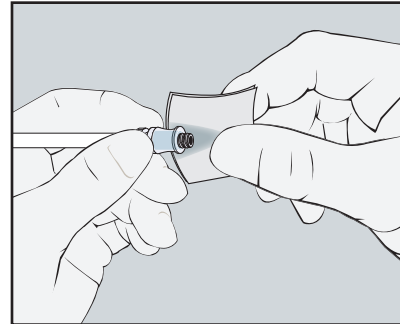

Hold the catheter valve end in one hand and vigorously clean the valve surface and around the valve with one of the alcohol pads.

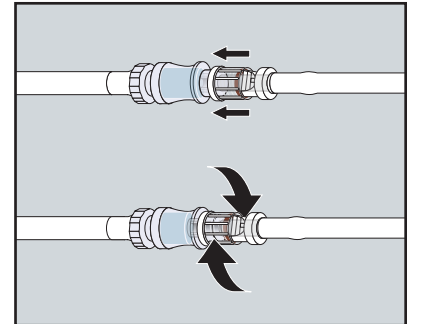

Remove the protective cap from the ASEPT® Connector on the drain line and align it in the center of the catheter valve. Push it in, twist clockwise, and connect firmly.

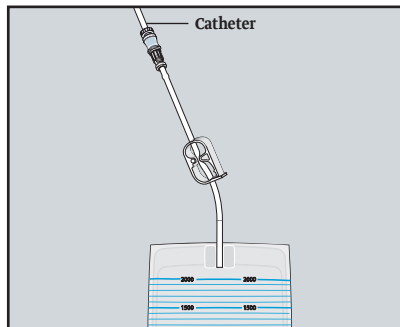

Place the drainage bag with the tubing below your catheter. The bag requires gravity to collect fluid.

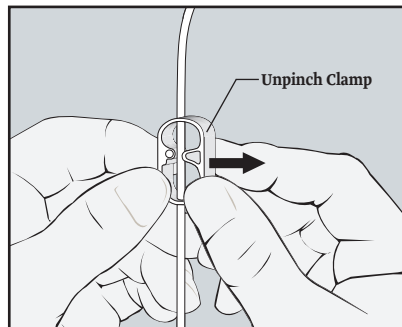

Release the pinch clamp on the drain line to begin draining fluid. The pinch clamp may be used to adjust the flow of fluid.

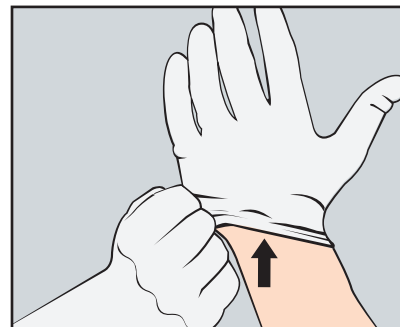

Remove your gloves and discard.

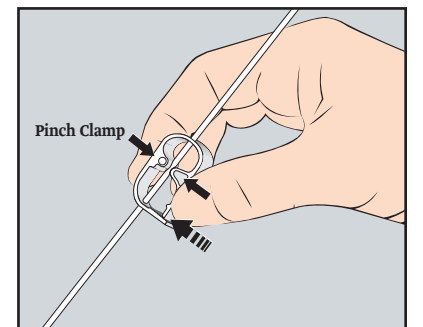

The fluid may slow down when it is almost completely drained or the bag appears to be full. Close the drain line by squeezing the pinch clamp completely closed.

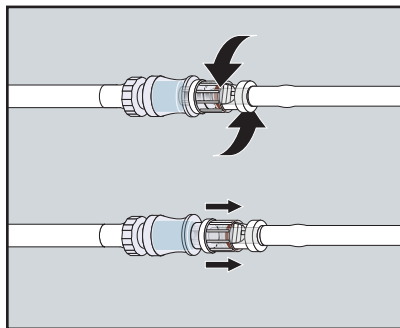

Disconnect the drain line connector from the catheter valve by turning the connector counterclockwise.

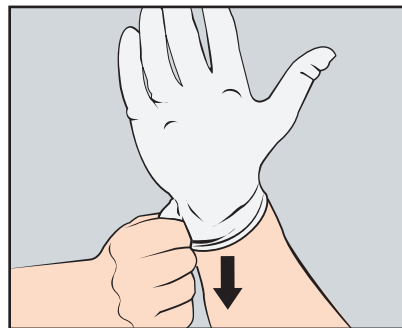

Put on the second pair of gloves. Pick up one glove by the wrist and put it on. Pick up the other glove by the wrist and put it on the other hand.

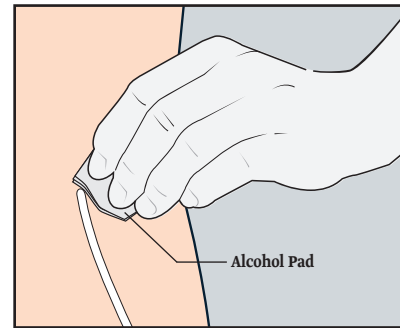

Disinfect the area around the catheter exit site with the two remaining alcohol pads.

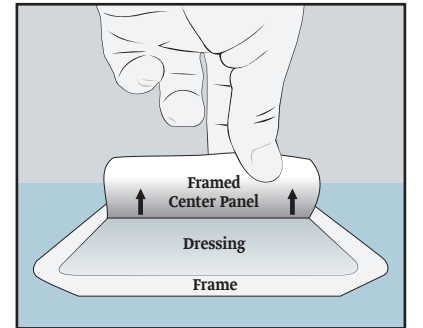

Remove the framed center panel from the self adhesive dressing. Put the dressing back on the blue wrapping.

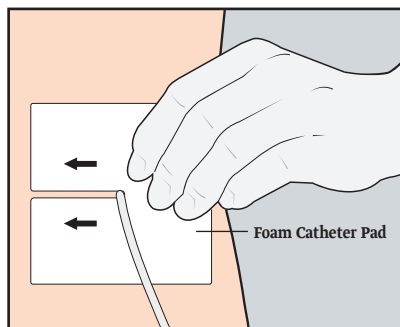

Place the foam catheter pad around the catheter.

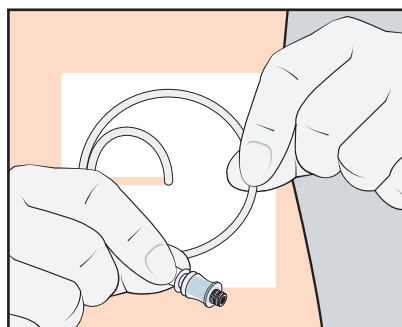

Curl the catheter around in a circle and place it on top of the foam pad. Be very careful not to kink the catheter.

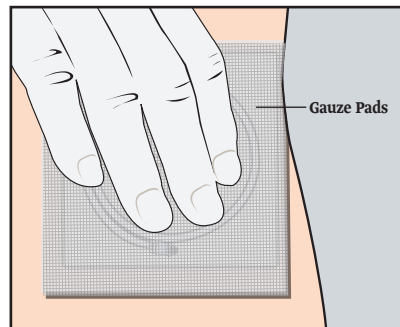

Place the gauze pads on top of the catheter and hold them down.

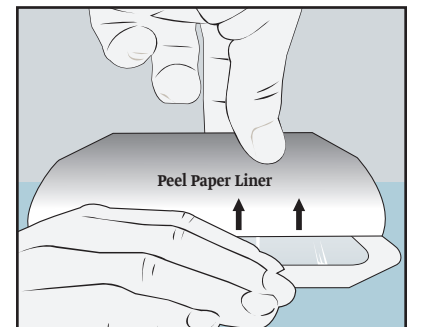

Peel the paper liner from the dressing, exposing the self adhesive surface.

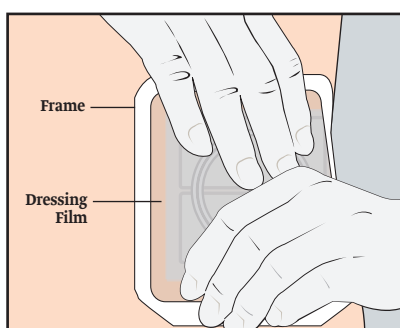

View the area where the dressing is to be applied through the film and center the dressing over the wound. Press it down.

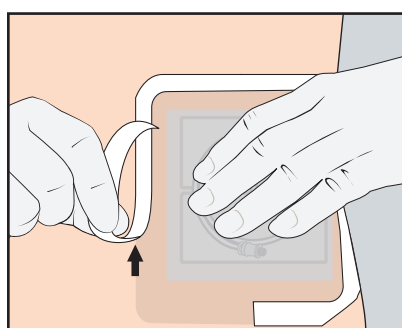

Slowly remove the remaining paper frame by peeling it off from the split section while smoothing down the dressing edges. Firmly push down the dressing from the center toward the edges.

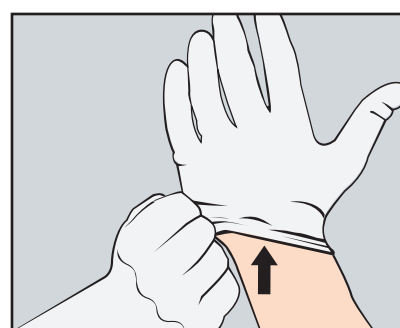

Remove your gloves and discard.

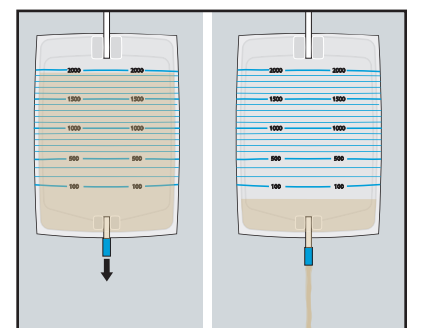

Empty the bag in the toilet or sink by pulling down the blue release valve on the bottom of the bag. Discard the empty bag.

Before using this product make sure that you have been trained by a doctor or nurse in the correct way to use the items in this kit. If you have any questions about the drainage procedure, contact your doctor or nurse.

Rx only
ASEPT® is a registered trademark of pfm medical, inc.
©2016 B. Braun Interventional Systems Inc.
CV2048 9/16

Distributed by:

B. Braun Interventional Systems Inc.

824 Twelfth Avenue | Bethlehem, PA 18018 USA

Tel 877 836 2228 | Fax 610 849 1334 | www.bisusa.org