

ASEPT® 600mL or 1,000mL Drainage Kit Procedure

A Step-By-Step Guide

The ASEPT® 600mL or 1,000mL Drainage Kit is to be used only for pleural or peritoneal drainage with the ASEPT® Drainage Catheter, which is included in the ASEPT® Drainage System. This poster should be utilized as a guide only. Read and refer to the Instructions for Use for detailed directions, warnings, precautions and other important product and procedure related information.

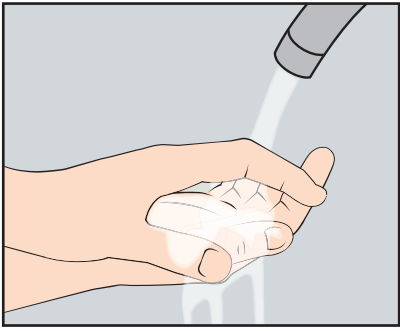

Wash your hands with soap and water for at least one minute. Remove the catheter dressing. If signs of infection are present, do not continue. Contact your doctor or nurse.

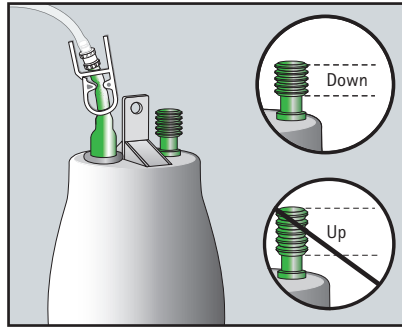

Pick up the bag that contains the ASEPT® Drainage Kit. Look at the green vacuum indicator. The indicator should be down, not up. If it is, open a new drainage kit and start over.

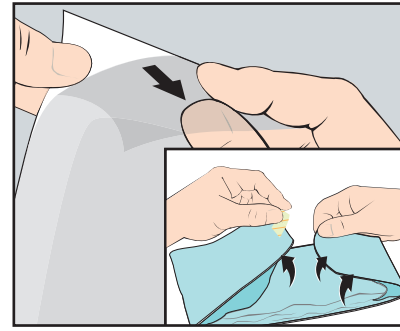

Peel open the drainage kit pouch all the way and remove the procedure pack. Peel open the procedure pack pouch. Remove the tape and unfold the blue wrapping.

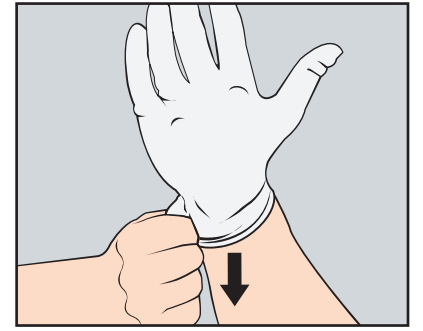

Pick up one glove by the wrist and put it on. Pick up the other glove by the wrist and put it on the other hand. Both gloves fit either hand.

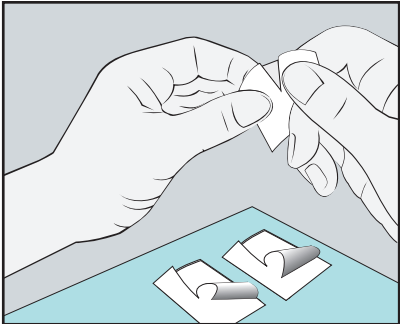

Tear open the three alcohol pads but do not remove the pads from the pouches. Place the pads on the blue wrapping.

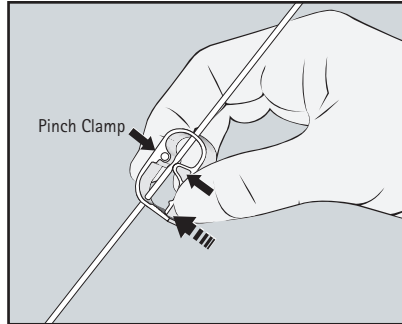

Pick up the vacuum bottle, remove the twist tie on the drain line, then squeeze the pinch clamp on the drain line completely closed.

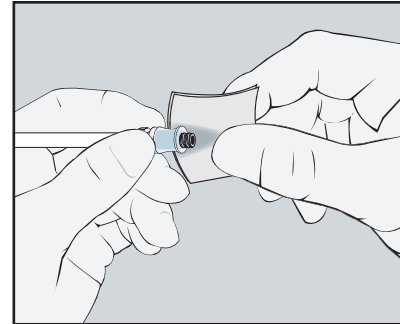

Hold the catheter valve end in one hand and vigorously clean the valve surface and around the valve with one of the alcohol pads.

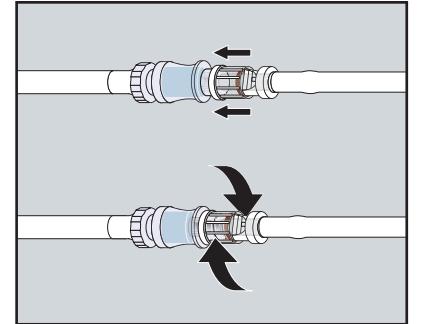

Remove the protective cap from the Spin-Lock® male luer connector on the drain line and align it in the center of the catheter valve. Push it in, twist clockwise, and connect firmly.

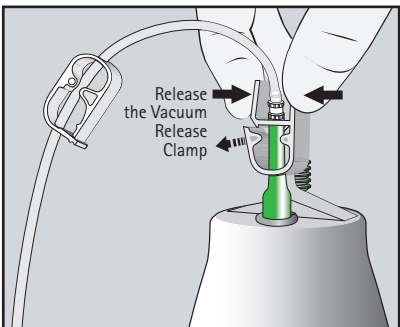

Release the white vacuum release clamp by squeezing it together until it no longer pinches the green tube closed.

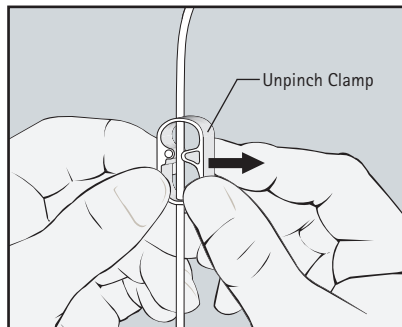

Release the pinch clamp on the drain line to begin draining fluid. If you feel pain or discomfort, clamp the drainage line to slow or stop the flow of the fluid.

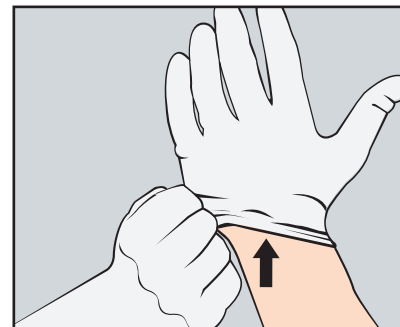

Remove your gloves and discard.

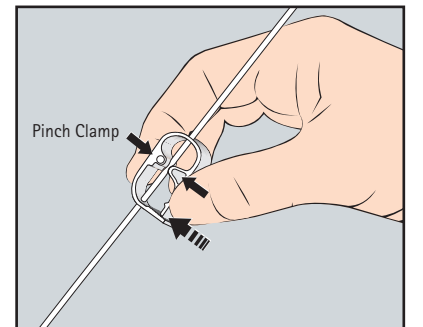

When the flow stops or the bottle is filled with about two-thirds of fluid or more, close the drainage line by squeezing the pinch clamp completely closed.

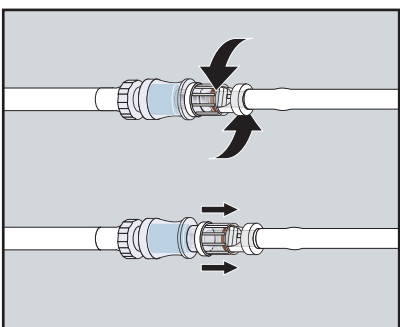

Disconnect the Spin-Lock® male luer connector from the catheter valve by turning the connector counterclockwise.

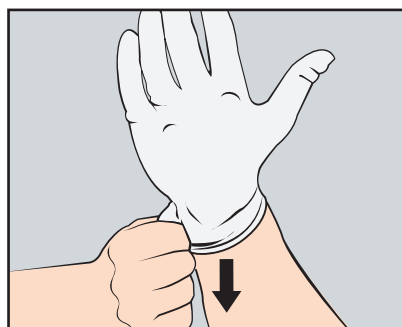

Put on the second pair of gloves. Pick up one glove by the wrist and put it on. Pick up the other glove by the wrist and put it on the other hand.

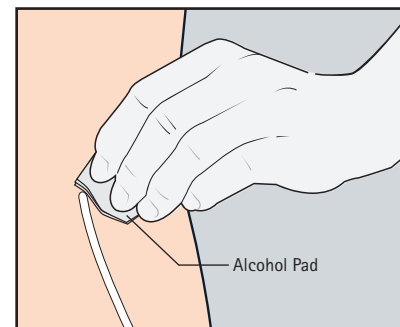

Disinfect the area around the catheter exit site with the two remaining alcohol pads.

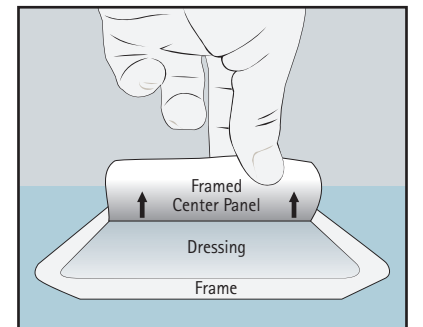

Remove the framed center panel from the self adhesive dressing. Put the dressing back on the blue wrapping.

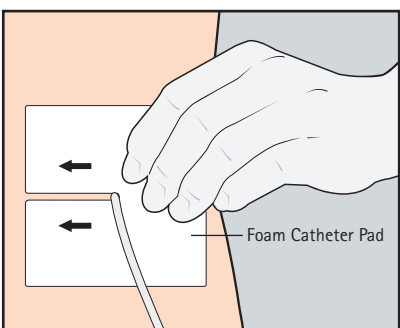

Place the foam catheter pad around the catheter.

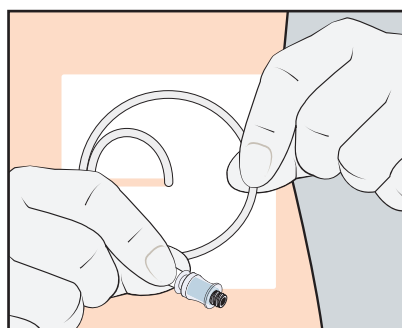

Curl the catheter around in a circle and place it on top of the foam pad. Be very careful not to kink the catheter.

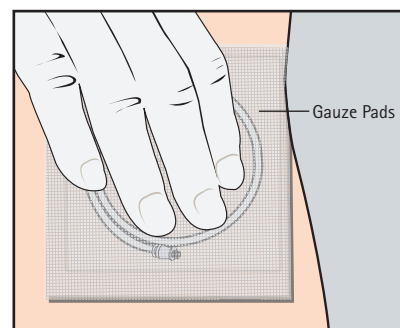

Place the gauze pads on top of the catheter and hold them down.

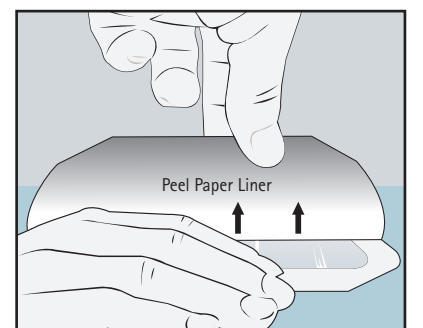

Peel the paper liner from the dressing, exposing the self adhesive surface.

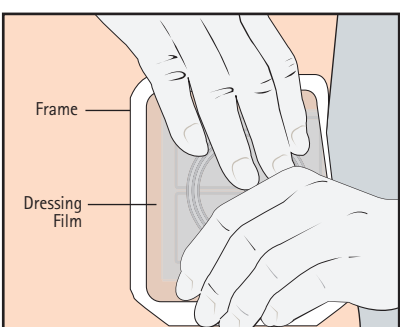

View the area where the dressing is to be applied through the film and center the dressing over the wound. Press it down.

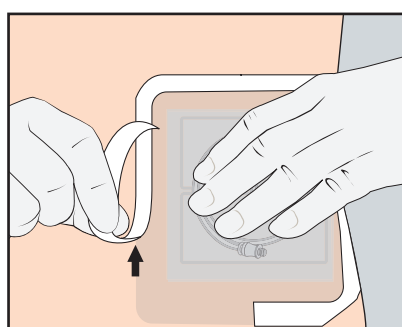

Slowly remove the remaining paper frame by peeling it off from the split section while smoothing down the dressing edges. Firmly push down the dressing from the center toward the edges.

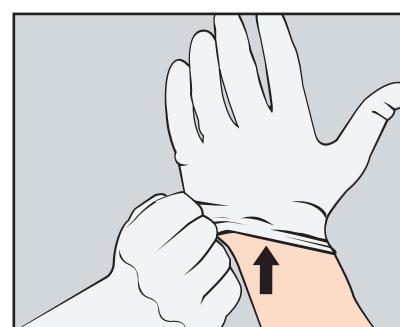

Remove your gloves and discard.

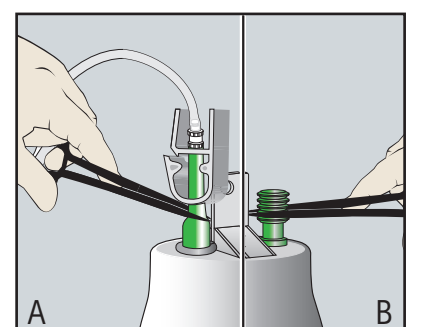

Pull up the vacuum release clamp slightly and cut the green tubing below the clamp (A). Cut off the vacuum indicator (B). Empty the bottle into the toilet or sink. Discard the bottle.

Before using this product make sure that you have been trained by a doctor or nurse in the correct way to use the items in this kit. If you have any questions about the drainage procedure, contact your doctor or nurse.

Rx only

ASEPT® is a registered trademark of pfm medical, inc. Spin-Lock® is a Registered Trademark of B. Braun Medical, Inc. ©2016 B. Braun Interventional Systems Inc. CV2027 7/16

Distributed by:

B. Braun Interventional Systems Inc.

824 Twelfth Avenue | Bethlehem, PA 18018 USA

Tel 877 836 2228 | Fax 610 849 1334 | www.bisusa.org